

Frame Styles

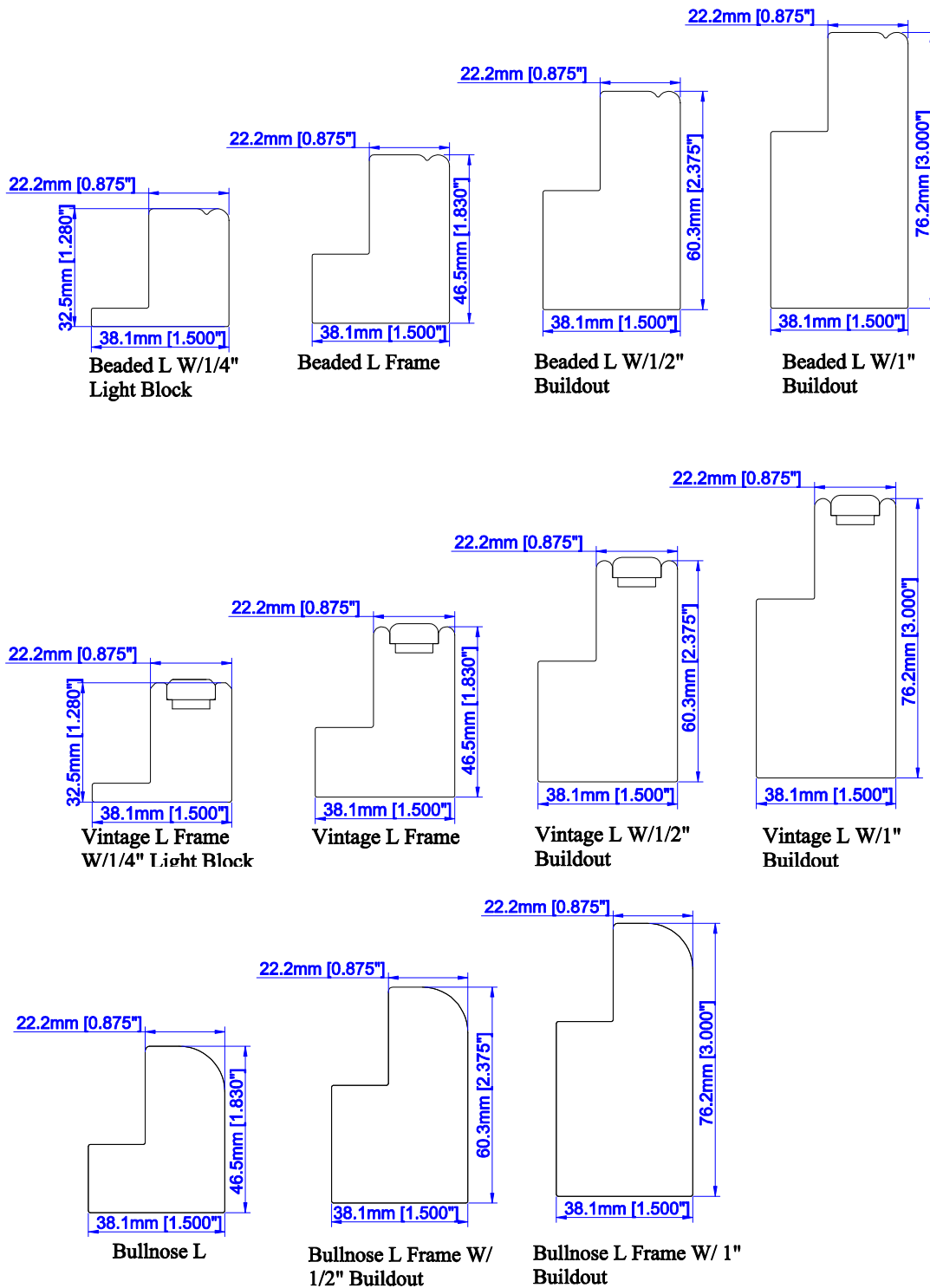

Also available

- Custom extensions* up to 2" for L frames

*Surcharge applies. Please see Options and Surcharges page for details.

Frame Styles

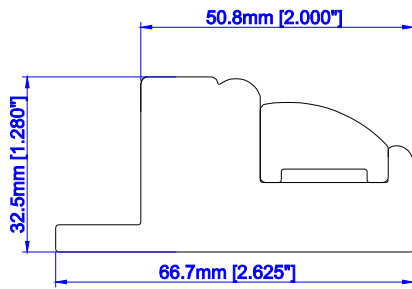

2" Camber Deco Frame

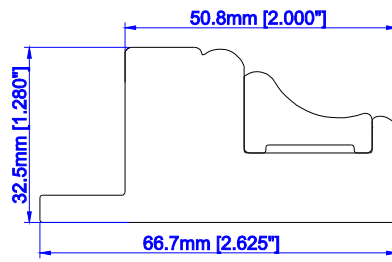

2" Classic Deco Frame

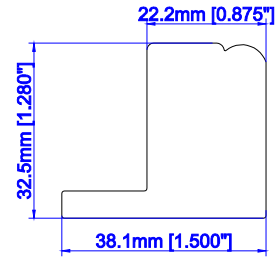

2" Deco Sill Plate

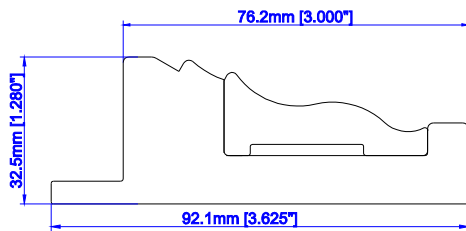

3" Ridge Deco Frame

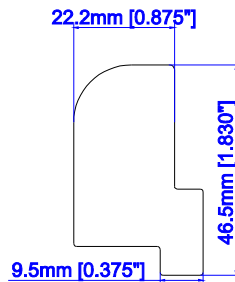

Tilt Out Z Frame

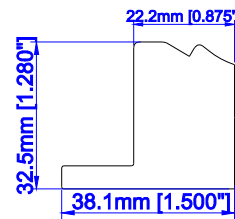

Ridge Deco Sill Plate

There are 2 options for the Deco frame installation when Window Size is given (Take Camber Deco frame as an example)

1. Default: light block part install into the window opening;

The window size is the exact size of the window opening;

The MFF size is the measurement of the entire shutter, including the frames;

The MFF size = Window Size + Face Width

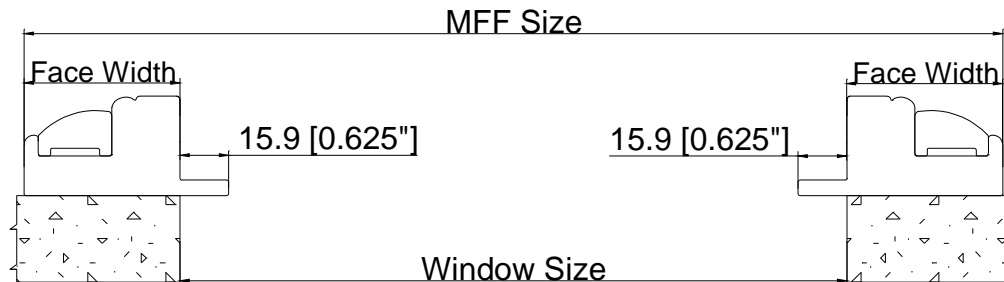

2. Optional: light block part flush with window opening.

The window size is the exact size of the window opening;

The MFF size is the measurement of the entire shutter, including the frames;

The MFF size = Window Size + Frame Back Width



*Surcharge applies. Please see Options and Surcharges page for details.

Frame Styles

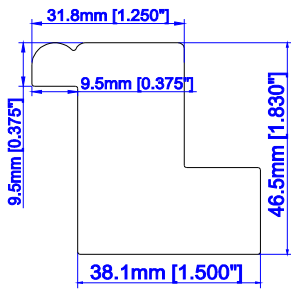

1 1/4" Beaded Z Frame

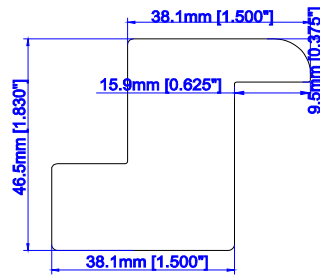

1 1/2" Bullnose Z Frame

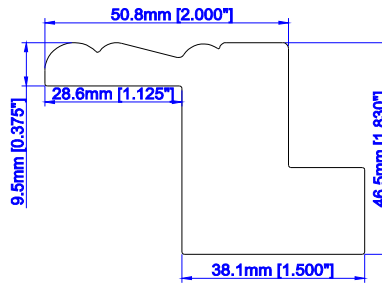

2" Bel Air Z Frame

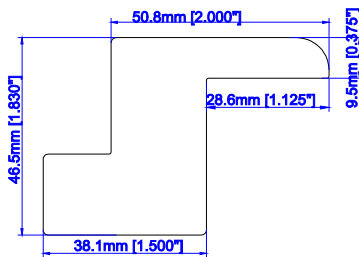

2" Bullnose Z Frame

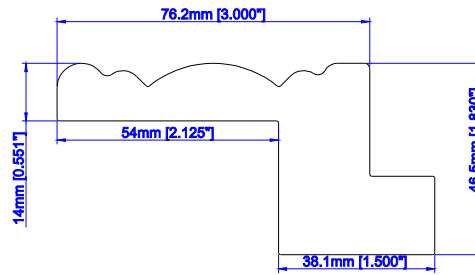

3" Crown Z Frame

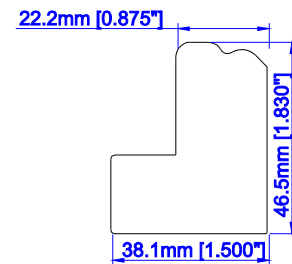

3" Crown Z Sill Plate

Also available

- Custom extensions* up to 1" for Z frames
- 1/2", 1" and 1 1/2" standard extensions* and custom extensions* up to 2" for Deco frames
- Custom extensions* up to 2" for hang strips (OM)

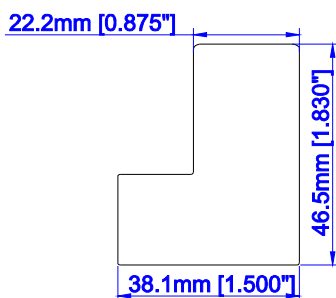

1 1/2" Bullnose Z
1 1/4" Beaded Z
Sill Plate

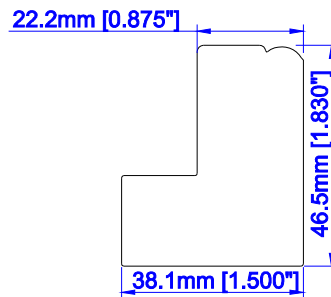

2" Bel Air Z Sill Plate

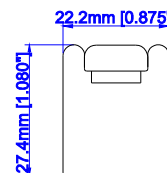

Vintage Hang Strip

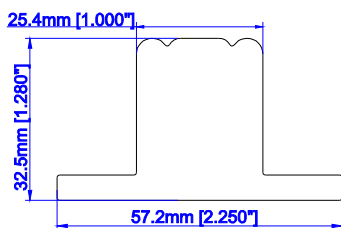

1" T Post W/ 1/4" Light Block
(Deco)

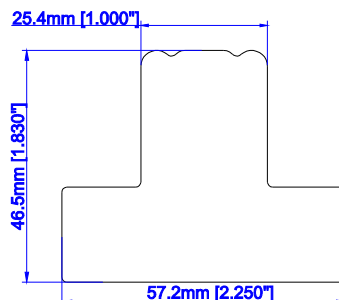

1" T Post W/ 3/4" Light Block
(L/Z/HS)

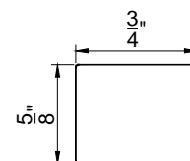

Light Block

*Surcharge applies. Please see Options and Surcharges page for details.

Frame Styles

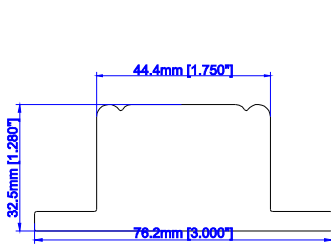

1 3/4" T Post W/ 1/4" Light Block (Deco)

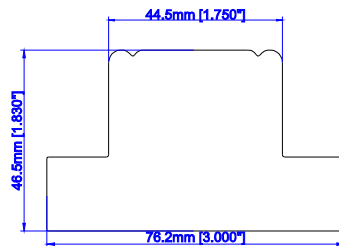

1 3/4" T Post W/ 3/4" Light Block (L/Z/HS)

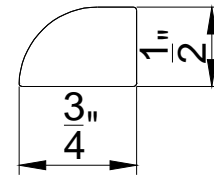

Quarter Round

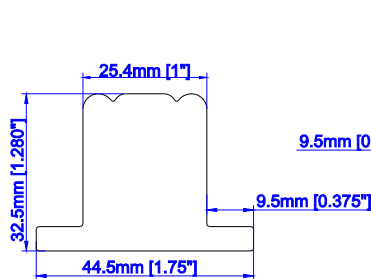

1" T Post W/ 1/4" Thick 3/8" Wide Light Block (Deco)

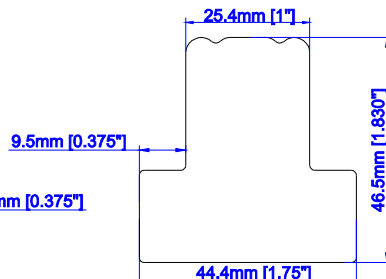

1" T Post W/ 3/4" Thick 3/8" Wide Light Block (L/Z/HS)

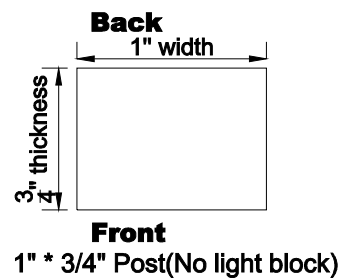

Front
1" * 3/4" Post (No light block)

Note: The 1"x3/4" Post (No Light Block) is only available for Direct Mount. And no hardware will be supplied to install it on the existing window opening.

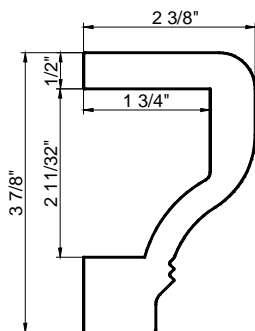

Curved Designer Sill Cap (L)

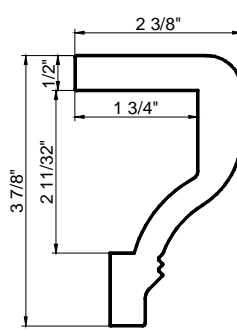

Curved Designer Sill Cap (D/HS)

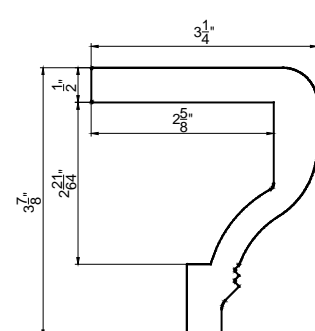

Curved Designer Sill Cap (Z)

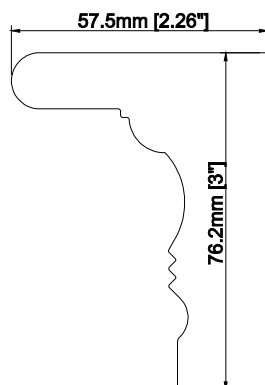

3" Deco Sill Frame

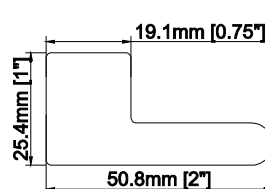

2" Sill Plate with 5/8" Light Block (L/Z)

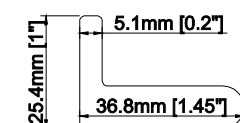

1.5" Sill Plate with 5/8" Light Block (Deco)

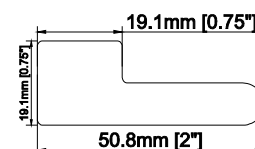

2" Sill Plate with 3/8" Light Block (L/Z)

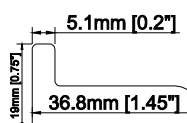

1.5" Sill Plate with 3/8" Light Block (Deco)

*Surcharge applies. Please see Options and Surcharges page for details.

Frame Styles

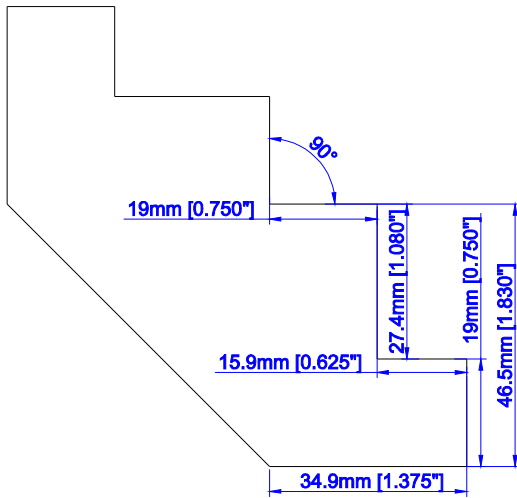

Corner Post W/ 3/4"
Light Block (L/Z/HS)

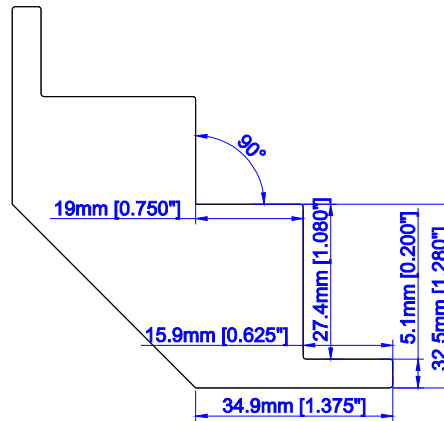

Corner Post W/ 1/4"
Light Block (Deco)

***Notch out corner post required if ordering Z Frame with solid drywall corner.**

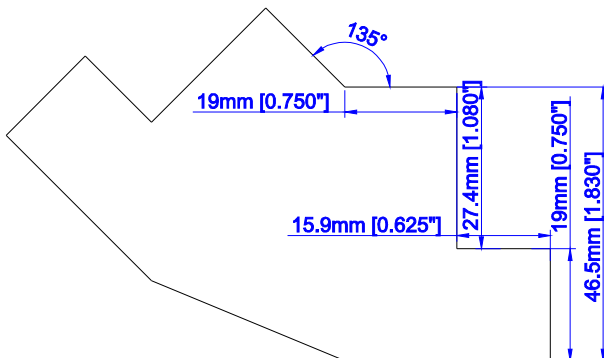

Bay Post W/ 3/4"
Light Block (L/Z/HS)

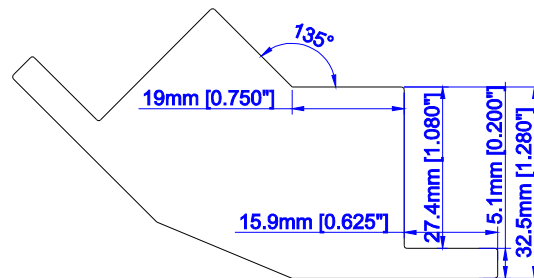

Bay Post W/ 1/4"
Light Block (Deco)

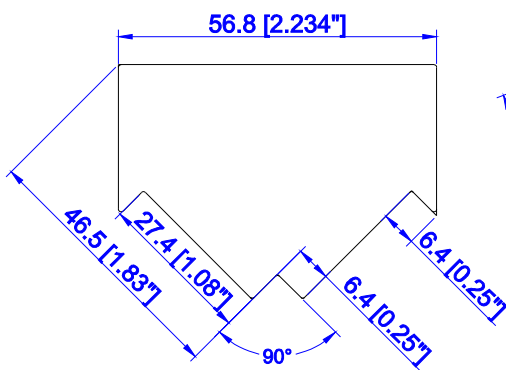

Slim Fit Corner Post for
90 Degree (L/Z/HS)

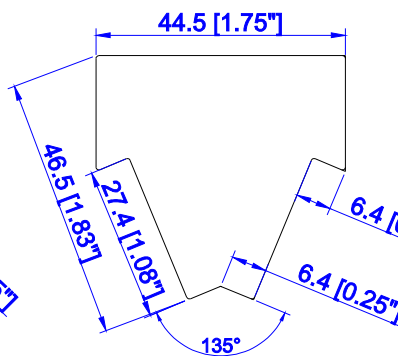

Slim Fit Bay Post for
135 Degree (L/Z/HS)

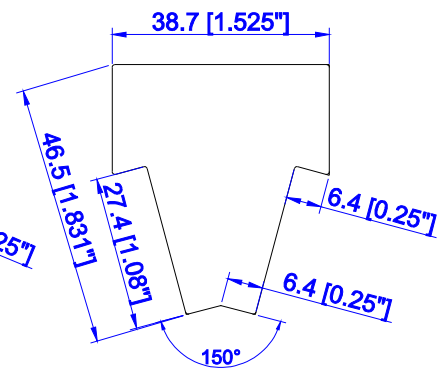

Slim Fit Bay Post for
150 Degree (L/Z/HS)

*Surcharge applies. Please see Options and Surcharges page for details.

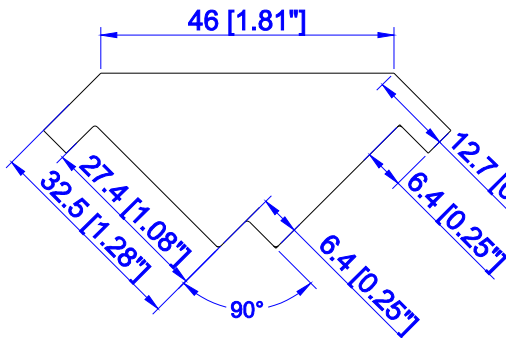

Slim Fit Corner Post for 90 Degree (D)

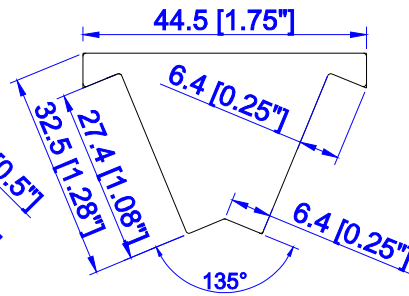

Slim Fit Bay Post for 135 Degree (D)

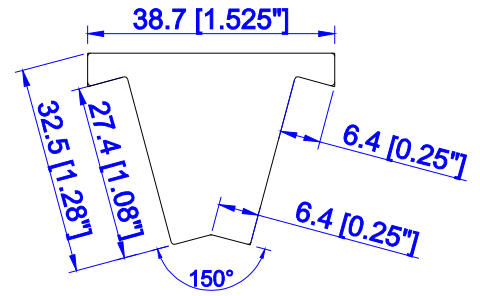

Slim Fit Bay Post for 150 Degree (D)

For bay window at 170 degree or above,

- 1" T Post with 3/8" light block will be used as Bay post;
- For Hang Strip (Behind Panel), bay post will be used.

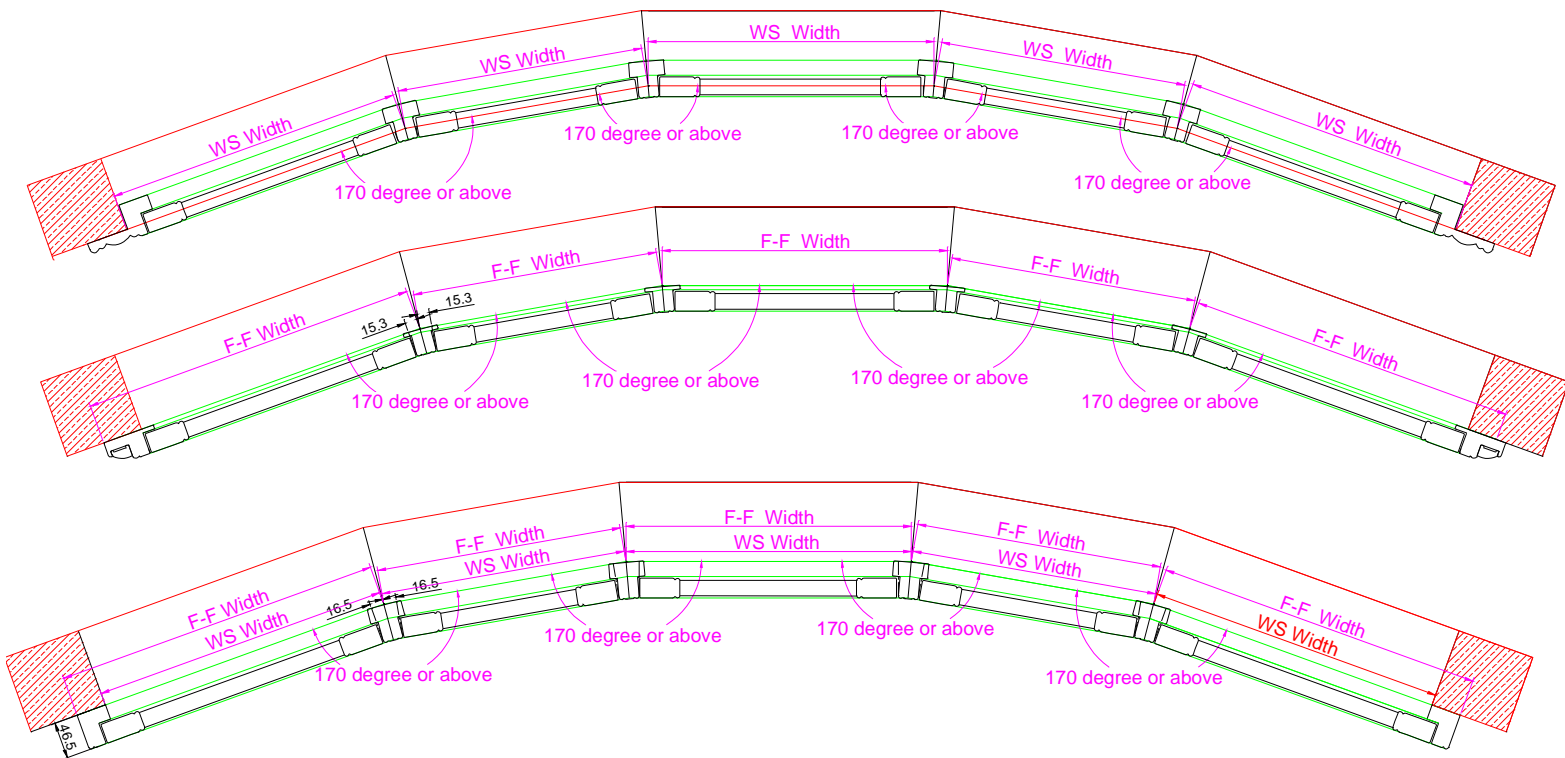

*Surcharge applies. Please see Options and Surcharges page for details.

Frame Styles

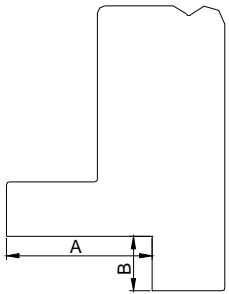

Notch Out
Beaded L Frame (A) *

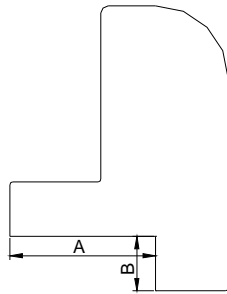

Notch Out
Bullnose L Frame (A)

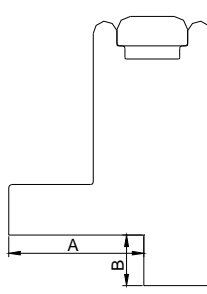

Notch Out
Vintage L Frame (A) *

Limitation for the Notch Out Size:
 $A \leq 1"$; $B \leq 1/2"$

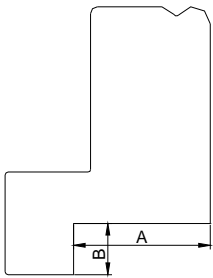

Notch Out
Beaded L Frame (B) *

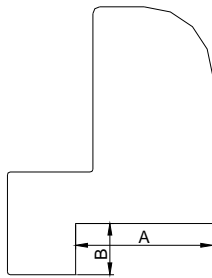

Notch Out
Bullnose L Frame (B) *

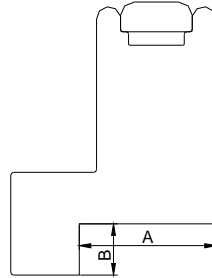

Notch Out
Vintage L Frame (B) *

Also available

- Custom depth* up to 2" / width* up to 7½ for T Posts
- Custom angle bay posts*

Pre-drill L Frames (Inside Mount Only) or Z frames:

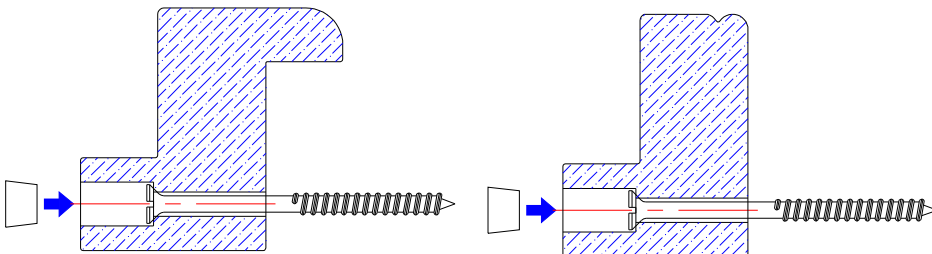

*Surcharge applies. Please see Options and Surcharges page for details.

Extension for Deco Frame* (Default to have full extension):

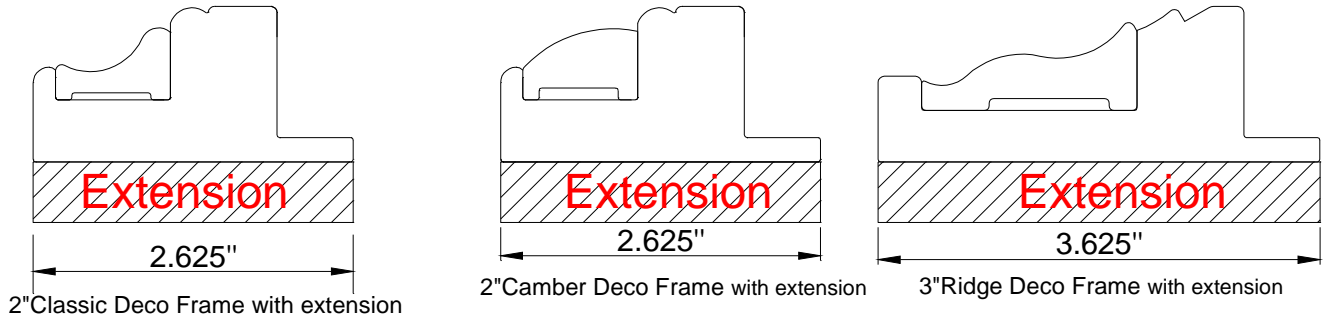

Note: When the extension thickness of the frame & T post is more than 2", the extension will not be attached with the frame and T post.